

ty Inc
tiative Integrity
Difference Legacy Quality
orators Volunteers Team Advocacy
Community Difference Initiative
Emmas Family Service Clients Initiative
Celebrate Remembrance Faith Collaboration
Volunteers Team
ocacy Inclusion Donors Customer-Centered Independence Legacy
s Initiative Integrity Mission IAmEmmaus Family Service Com
Community Difference Legacy Quality Celebrate Remembrance Faith
Collaboration Volunteers Team Advocacy Inclusion Donors Cus
omer-Centered Independence Community Difference Initiative Integrity Qu
AmEmmaus Family Service Clients Initiative Difference Legacy
ity Celebrate Remembrance Faith Collaboration Independence Legacy
ty Integrity Mission IAmEmmaus Family Service Clients Initiative
Quality Celebrate Remembrance Faith Collaboration Independence Legacy

Annual Report 2017-2018



celebrating the legacy

Letter from

Cindy Clark, President & CEO

Dear Friends,

This year marks an extraordinary milestone for Emmaus Homes. For **125 years** our faith-based organization has been providing services for adults with developmental disabilities.

Since our humble beginnings in 1893 on a former seminary campus in Marthasville, Missouri, Emmaus has remained singularly focused on providing the best possible care for those we were entrusted to serve. Today we serve nearly 300 clients in 84 homes in St. Charles, Lincoln, Warren, Franklin and St. Louis counties.

We are truly, as our 125th anniversary campaign says, **“Celebrating the Legacy.”**

I have been blessed to be part of Emmaus Homes for nearly 10 years. And on this occasion, I couldn’t be prouder to celebrate the organization’s greatest achievements along with its greatest assets, each of you – **our clients, donors, employees and volunteers.**

In this very special year, there can be no more perfect connection between our legacy and the future than to acknowledge our incredible staff who’s work with our clients is what truly makes Emmaus extraordinary.

Recently, while reflecting on our history, I was reminded that our industry has long struggled with staffing issues. Determined to help solve this crisis, our Board of Directors made a bold decision to invest more than \$10 million over the next 3 years to help stabilize our workforce AND provide a living wage for our staff who care directly for our clients each and every day. We’ve crafted a **‘Grateful Family’** campaign to not only help us fund this initiative, but to also assist us as we work to advocate at the state and federal level for their loved ones.

Which brings us to my favorite part of our job: **What’s next?** Our team continues to focus on improving the lives of those we serve in many ways, including a recent redesign of our client services structure, which will provide much more personalized services for clients and their family members.

We’re also utilizing new technologies to help our clients live more independent lives. Our spiritual care services continue to evolve through community-based offerings including bible study, home visits and worship services. And lastly, generous donors have helped ensure that our archives will be preserved for many years to come.

We have some wonderful plans in store to celebrate our anniversary over the next year.

Here’s a sampling of some of the things you can look forward to:

5th Annual Duckfest – Saturday, October 6
Emmaus 125th Gala – Saturday, February 23

We are also working on details for a final worship service at the Marthasville Chapel later this year along with the opportunity for guests to view our archives and share their memories.

In closing, I’d like to thank you for the continued generosity we receive from our donors. I thank God that He has touched the hearts of so many of you who generously support our clients. We can only do this critical work because of you and your faithful support.

Blessings,

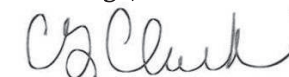

Cindy Clark
President & CEO



P.S. – Some stories in this report are written in the past. At the time they were written, what we consider people first language may not be included. They will be denoted with an *

Emmaus Homes Executive Team

Cindy Clark
President and CEO

Lisa Key
Chief Development Officer

Jon Holt
Chief Financial Officer

Michelle Peters
Vice President of Client Services

David Kramer
Chief Operating Officer

Stacy Kohr
Chief Human Resources Officer

Rev. Cindy Bumb
Vice President of Spiritual Care

Dawn Edgington
Executive Assistant/Office Manager

Financials & Client Info

Revenue

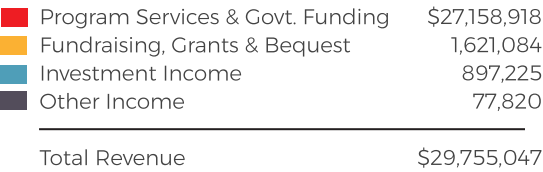

Investments

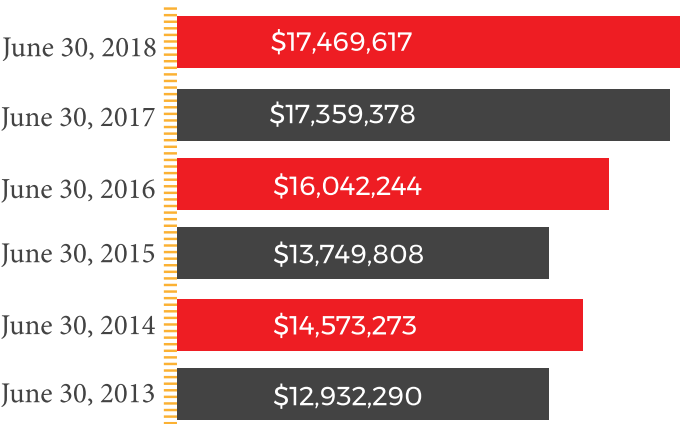

Statement of Net Assets

Unrestricted / Board Designated for:		
Operations	\$3,929,790	
Property & Equipment	\$5,511,007	
Endowment	9,887,327	
<hr/>		
Total Unrestricted	\$19,328,124	61.85%
Temporarily Restricted	\$3,495,245	11.19%
Permanently Restricted	\$8,424,438	26.96%
<hr/>		
TOTAL NET ASSETS	\$31,247,807	100%

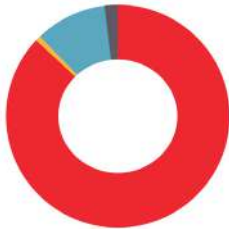

Expenses



271 adults with cognitive or developmental disabilities are served by Emmaus.

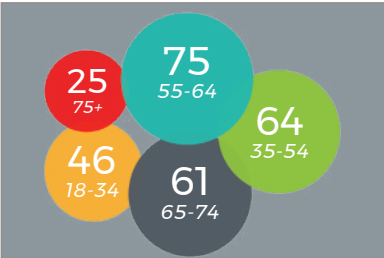

Age

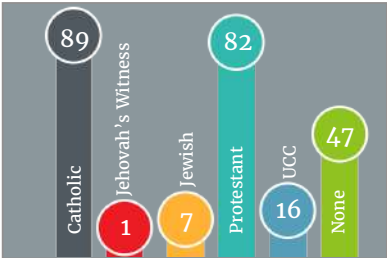

Religion

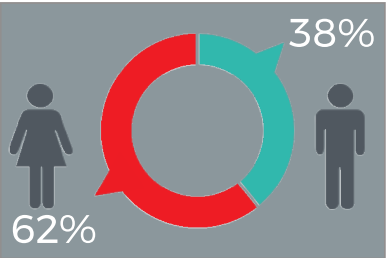

Gender

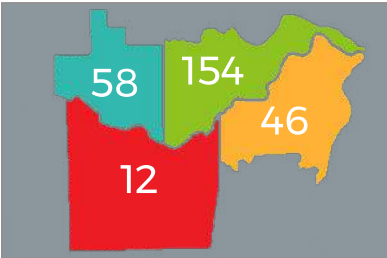

Individuals Served

*1 Individual in Lincoln County



Homes Served

*1 Host Home in Lincoln County

Emmaus Homes Board of Directors*

Rev. Lev Reynolds, *Chair*
Emily Ingalls, *Vice Chair*
Nancy Droesch, *Treasurer*
Trudi Rychwalski, *Secretary*

Joyce Berkowitz
Chuck Gross
Barry Haith
Meredith Jones
Jason Koelling

Lois Kruse
Ann McKee
Kevin Moehring
Jack Moran
Rev. Rick Oberle

Shawn Saale
Sheila Schuette
Carolyn Skowyra
Stephanie Sliefert
Gael Wood

*as of June 30th, 2018

Celebrating Faith

On July 2, 1893, the first building of the Emmaus Home at Marthasville was ready for occupancy and later that year, we welcomed our first clients. Our roots connect to what is now Eden Theological Seminary. In 1850, the Kirchenverein des Westens (Synod of the West) of the German Evangelical church opened a seminary to train men as pastors for the many congregations organizing across the American frontier. The seminary opened on land outside of Marthasville, MO, however later moved to the St. Louis area in 1883, leaving the campus buildings unoccupied and unused. Two local Evangelical pastors had been thinking about opening a facility to serve people with epilepsy who could not be cared for in their homes. These leaders connected with another pastor who had experience in the care of people with epilepsy and who knew of similar work being done in Germany. These men formed a Board of Directors with others from the Evangelical Church. It was decided to take over what had been the seminary's buildings and land. Thus, the Emmaus Home to serve people with epilepsy and intellectual disabilities was born.

Many people with disabilities came to Emmaus to live, and within 5 years, it became clear that another facility was needed. A farm just outside St. Charles, MO was purchased, and a building to house 16-18 residents* was constructed. In the fall of 1901, the Emmaus Home at St. Charles opened and received its first resident. Since more women than men were applying to live at Emmaus, the St. Charles campus began by serving women.

The church supported Emmaus in many ways. Some members served on the Board of Directors, making the very first decisions about acquiring land, constructing buildings, hiring administrators, and serving residents. Some churches gave land and money so that the campuses could expand. And many more contributed food and material goods for campus operations.

While much has changed over 125 years, much more has remained the same – including the deep love that members of the United Church of Christ hold for the clients we serve. We give thanks to the United Church of Christ for their continued support of our mission and ministry. Thanks be to God!



Travelers of Jesus

David was adopted at 21 days old. Later he went to school for testing in Wichita, Kansas and after getting his results, he was placed in one of the first schools opened for people with disabilities. Due to his inability to speak, David received little attention.

David stayed at home until he decided to move to Missouri at age 49. He sought government services to get help with his next step and was pointed to Emmaus. He liked the thought of living on his own and staying close to his family, while being able to make his own decisions.

One of his first decisions, was to get involved with motorcycles. David had always loved bikes and so he joined a motorcycle group as an honorary member.



As time in the group passed, he started to realize this group wasn't the right fit.

"I could do nothing but wear their name and started feeling ignored. It wasn't good because I wanted to do something with them, and after 2 years I told my friend I was unhappy to just wear their name, so I left." David shares.

David's father went to a church close to where he was living. David started attending and learned it was also a biker church, home to the group Travelers of Jesus. David was at a meeting when Jim, the leader of Travelers, gave the non-members the membership paper. With David's experience, he thought long and hard about joining another group and when he asked if it was honorary or full membership, Jim responded with "Full."

When David told him that he didn't own a bike, Jim said, "Don't worry. Your chair is your bike!" David even adopted the nickname Wildman.

"David came to our church about 5 years ago. His smile can turn someone's day around, and he lights up our world as much as we do his. Wildman loves to be involved and has blessed us from the start." says Jim. Everyone treats David as an equal.

Now he gets to impact other people's lives. David rides for whatever God puts in his path. He's visited with Great Circle (Boy's Home) in St. James and serves as a mentor to the kids when the Travelers roll-in on their motorcycles. They share devotions, and he's witnessed people finding Jesus after an altar call.

It's a common practice that the Travelers of Jesus bless new bikes as they're bought, for protection and safety on the roads. David also participates in the Ride for Rocky, which is just one of the charity events that raises money for Cardinal Glennon Children's Hospital and other local groups. One of his fondest memories with the Travelers of Jesus is when a member bought a sidecar, made some adjustments, and took David for a ride around Westport.

Today, David serves as Sergeant of Arms for the Travelers of Jesus.

166

Bible Studies & Worship Services Offered

130

Clients Participated in Worship/Bible Study

734

Churches/Fellowships Support Emmaus Thru Gifts/Donations



- Pastor Andrea

"I am amazed by the assistance and support that I have been shown. Everyone has been very helpful in helping me to meet people, understand how things work, and get acquainted with the Emmaus Homes Community. Everyone is a joy to work with!"

Celebrating Team Members

Learn From Each Other

The saying, "I learn something new everyday," has certainly been true for me as I reflect on my summer here at St. Charles Emmaus. My job has been guiding and assisting residents* in the craft program. I really don't think of it as a task that is my duty to fulfill because the girls have given me more than I could ever give them.

For this reason I think of my work as a delightful challenge of living together in harmony. Naturally this means that we all must be willing to listen to the opinions and feelings of another person. I think this is the best way to learn something from each other.

In case the girls are unaware of how they have made my life happier and more complete, I would like to tell them. The most important things like love and understanding are very present in your lives. You showed this in many ways - sometimes a helping hand, sometimes just waiting patiently until I could start you on

a project. And then there were those sincere words of appreciation and liting laughter - such priceless gifts! I will fondly remember the "I love you"; who doesn't feel a need to be loved?!

Above all else, I will always cherish our informal talks about Jesus; and your eagerness to know more about Him and sing praises to His name. Such joys make me feel closer to Jesus also.

Even though I have spoken in particular of the girls who came down for crafts, I want to thank each and every one of you for giving yourselves to me. In this glorious, humble way, I know the sense of fulfillment that can be attained and it is my wish that attendants and residents will continually strive to benefit from learning from each other.

- Written by Pat Foltz in the Emmaus Messenger, 1970.



In this picture, Pat is seated in the upper center, at the end of the table - her usual smiling self.

*Handicapped*by cerebral palsy and getting about in a wheelchair, Pat has been an inspiration to all of us. When she returns as a Junior to Southern Illinois University for the fall term, we at Emmaus will certainly miss her.*

- Response written by Emmaus to Pat in the Emmaus Messenger, 1970



Family

For over a year, Emmaus team members were asked to describe Emmaus in three words. One word overwhelmingly rose to the top of the list. **Family.**

It's not that surprising that this word appeared again and again. Many team members don't expect the quick bond they develop when joining the Emmaus family. Everything that happens during the countless hours with clients becomes very personal and heartfelt. Everyone works diligently and brings their passion to life through the care they provide. There are many valuable experiences and a lifetime of memories that follow.

However, there is another reason why "family" describes Emmaus.



For 125 years, people have been encouraging their real-world family to consider joining our Emmaus family. Today, it's not a rare occasion that working at Emmaus is a shared experience between siblings, parents and children, husbands and wives, and even extended family members.

One team member introduced her career to her mom, and then her sister. "I don't really get to work with my mom much, since she works overnights in Marthasville, but it's nice to have someone to talk to who understands what you're talking about. Emmaus is such an important thing to me and I am thrilled that I get to share the fun times, sad times, stressful times...all of it with them!" Sabrina D.

Another team member recently celebrated



her 40th anniversary with Emmaus. Her mom made a surprise visit. "I used to bring Rhonda along with me when I worked. She became old enough to work, and then passed the tradition down to her son, Brian. One thing that hasn't changed over 40 years is the rewarding opportunities that come along with caring for individuals with developmental disabilities."

"Our family is blessed with spending more one-on-one time with clients," says Romana R. Working with her sister and daughter, Romana says their true passion and advocacy for people comes to life. Romana works with her sister Ronethia in the office and feels relieved knowing her daughter has a rewarding career working as a Home Manager. "We're happy to have our family part of the Emmaus family!"

729

All-Time High
Staff Headcount

284

Direct Support
Professionals
Hired in 2018

25,318

Hours of
Training



- Lisa R.

Celebrating Volunteers

The Heifer Project

Raking leaves, cleaning barns, and hauling manure are usually not highly anticipated activities for a group on vacation. However, those activities and many more like them were the daily routine for a group of individuals from Emmaus who volunteered at the Heifer Project International's Learning and Livestock Center in Perryville, Arkansas. The Heifer Project is a 1200-acre farm and a self-help ministry, providing animals for the needy around the world.

Emmaus residents* would journey with staff to this educational retreat and livestock holding center in central Arkansas. The 12-hour drive to Perryville begins at 6:30 a.m. and the group arrives later that evening in time to shop for the weeks' worth of breakfasts and dinners, and settle into the "Heifer Hilton," an open-air bunk barn which has canvas curtains for outside walls.

The next day, the group checks in to the Retreat Center, which offers modern accommodations in two lodges. According to staff in 1995, this move provided for better sleeping conditions which helped prepare the mind for their busy week

ahead. The week's work activities consisted of morning and evening meal preparation, mail assembly, folding souvenir t-shirts; cleaning sheep barns, organic gardening and yardwork.

Several leisurely activities were also a part of the week. These included buying souvenirs and hiking the Educational Trail, which features demonstrations of small-scale farming. Included along the trail is the Global Village, which is a unique environment that demonstrates the living conditions of many rural communities. worldwide Dinners out to a local restaurant were also worked into the week's evening activities.

"Before we even left, the guys were asking when they could return," noted a past Emmaus team member. "We're glad that their experiences were so positive."

Heifer Project participants were selected for the trip because of their previous experience with Heifer, while others were chosen because of their farming background. Some were selected because the exposure to these types of activities would be a beneficial experience to their lives. According to Emmaus team members, the trip was beneficial for ALL participants, "The guys

really felt that they had a sense of mission and were giving of themselves to help out with a worthy cause."

The Heifer Project has helped more than one million impoverished families around the world become more self-reliant through the gift of livestock and training in its care.

- Amended from the Emmaus Messenger, 1995





Mastercard

There is nothing that harvests more of a feeling of empowerment than being of service to those in need. For more than 3 years, Mastercard volunteers have taken a great weight off our staff's shoulders by doing just that.

Most know Mastercard as one of the world's largest payment processing networks, but did you know about their commitment to volunteerism? From local projects to global challenges, Mastercard has created an enduring impact on the communities where they live and do business. It's not surprising that for the 3rd year in a row, Mastercard was named one of 2018 World's Most Ethical Companies which recognizes organizations for their role in influencing positive change around the world.

Emmaus has seen Mastercard's devotion in action as their volunteers have accomplished a large variety of tasks at many of our community homes; from intensive yardwork to widening driveways and building walkways. This year alone, volunteers from Mastercard have already done LOTS of landscaping, power washing, interior and exterior painting, and office work for Emmaus.

At one of their most recent projects, Mastercard volunteers helped prepare a home for move-in day, which involved 8 hours of cleaning and packing. They also worked on another home in St. Charles to completely replace all the landscaping and rock work for a huge curb appeal upgrade. Soon they'll switch gears and work inside to assemble more than 600 gifts for Direct Support Professionals Week.

Helping with these work projects not only supports our clients and staff, it also provides an educational and uplifting experience for the volunteers. Many volunteers leave feeling like they have gained a better understanding about Emmaus' services along with new, valuable connections within their own communities.

Mastercard is one of *over 50 unique* corporations, organizations, churches and schools that provide volunteer service to Emmaus annually, whom we depend upon to help meet our mission. To date, **132** Mastercard volunteers have clocked in a total of **413** service hours at **16** different homes throughout St. Louis and St. Charles counties. It takes a village to move a mountain, or sometimes just a dedicated volunteer group!

3,210
Volunteer
Hours

823
Volunteer
Visits

45
Volunteer
Groups



-Mastercard Volunteers

"Mastercard volunteers come back energized about the work they do with Emmaus, whether raking leaves or building drains, their experiences are truly invaluable"
Deann Donohue, Director of Community Relations

Celebrating Family & Donors

1991 – Letter From Dr. Allrich

This letter is in response to your recent letter, informing me that the Board of Emmaus had voted to name the remodeled administrator's home "The Allrich House." This comes as a delightful surprise and I feel highly honored, not only for myself but on behalf of the whole Allrich family. I mention the family because many members of the Allrich family have been intimately related to the St. Charles home since its beginning.

My father, who was the pastor at St. John in St. Charles was president of the Board when the Emmaus property was purchased and the 1st building erected in 1901. My mother, a native of St. Charles was among the first workers at the time (as well as my sister) and my father married her after his first wife passed away. About 1907 he accepted a call to a church in Iowa. When he passed away in 1917, our mother with five children moved back to St. Charles and in the ensuing years we often visited the home.

Later, my sister Marie, worked at the house before she became an RN. My brother, Fred, worked at the Home when he was at Eden Seminary (also met his wife there) and later he was a member of the Board for many years.

When I was at Eden, I did some summer work at the Home and it was at Emmaus that I preached my first sermon – in the Merten Building Chapel.

My years as Superintendent/Chaplain began in 1964. At that time the home was still a rather isolated institution, depending largely on donations received from churches. Needless to say, we lived on a very limited budget but with the help of a dedicated staff and a supportive Board, we managed to survive. My indispensable coworkers were my wife, who became the unofficial interior decorator of the Home, and my sister Martha who was my registered nurse. When State licensing was required, it brought about many changes, but we also began getting some state and federal funds.

Over the years, we managed to do much renovation, build new buildings, institute rehab programs, increase staff, acquire United Way and county support etc.... Humorously, I must add that all these improvements were made on balanced annual budgets – thanks to the watchful and concerned eye of Ted Bruere.

In all honesty, I must say that it was quite a challenge to keep the good ship Emmaus on an even keel during those 16 years of many changes, and, whatever progress we made was due to a sympathetic family, a supportive board, and dedicated staff.

When I retired in 1980, I had the satisfaction of feeling that we had accomplished a great deal and that Emmaus was poised for an even greater future. During my 10 years of retirement I have rejoiced to

see signs of continuing improvement and the base of support growing wider and wider.

This letter is longer than I had intended, and I hope that I haven't bored you, but I thought you might appreciate knowing a segment of Emmaus' history and something about the Allrich relationship to the Home, especially since you are a newcomer. Thank you again for your kind letter and please convey to the Board the appreciation of my wife and I and the other Allriches.

May God continue to bless the compassionate work of Emmaus, the dedicated efforts of yourself and your coworkers, and the supportive service which the Board performs.

– Excerpted from a letter written to the Emmaus Board of Directors from retired Dr. Rudolph Allrich





Strong Supporters

Ashley Viehmann Milam grew up in Immanuel United Church of Christ, in Ferguson, Missouri. She frequently heard about the mission and ministry of Emmaus Homes though her church, which has been a strong supporter of Emmaus for many years. It was instilled in her from a young age that it was important to support those who have been marginalized by society.

Ashley always thought the mission was important, but about a decade ago, when her nephew, Anthony, was born with Down syndrome, it reinforced this idea. It was at this time, that Ashley and her husband James Milam, became consistent donors. It is especially important to Ashley to make sure that adults with developmental disabilities have a resource like Emmaus. "For some people, their parents and

guardians might not be able to provide the right care: financially, emotionally, or physically. Emmaus is ready and willing to step in and do whatever is necessary to meet those needs" Ashley says.

Ashley represents the next generation of donors who will keep Emmaus' mission moving forward. She is a millennial and a professional in the field of science. She and James also understand the importance of consistently supporting causes that mean the most to them. We were able to sit down and talk with Ashley to learn more about her "IAmEmmaus" story:

Emmaus: How would you describe the Emmaus mission to someone else? What does it mean to you?

Ashley: Bringing happiness, health, community, and joy to adults with developmental disabilities. Making sure they live the fullest, highest quality of life possible.

Emmaus: We know that your nephew is a big reason why you choose to support Emmaus. Are there other reasons why this cause is important to you right now?

Ashley: Sometimes people, like the clients Emmaus serves, and other members of society, might not have a lot of visibility. They may not have a big voice in how things are done or how policies are made. That does not mean they are not absolutely important. We should make sure that there is always someone there to advocate for them. I think that it is great that Emmaus keeps the needs of people with developmental disabilities front and center.

Emmaus: We hear that millennials are results-driven. As a younger supporter, what kind of results to you expect from an organization like Emmaus?

Ashley: Full living within the community. Especially now that we have moved away from the group living. I would hope to see clients feeling a quality of life out in the community and in their homes. But also, that members of the community would see them and how meaningful their lives are.

Emmaus: What has surprised you most about Emmaus?

Ashley: What has been possible with the community living model. Moving away from the well-known institutional setting was a big step. My eyes were opened when I realized how much work has been done to include everyone into the general population; how hard the caregivers and staff work to make that possible. When I heard this transition was coming down the turnpike, I wondered how it would go. But after taking some time to learn about the process and hearing some clients' personal stories relayed by an Emmaus staff member, it seems it is really working well.

Emmaus: Thank you so much for sharing your perspective with us. As we close, is there anything you wish other people knew about Emmaus?

Ashley: That anybody can be referred, irrespective of their financial situation or religion. Emmaus is open to everybody who needs their services. Though Emmaus is a faith-based organization, everyone is treated equally and served equally.

\$400
Dollars Given
per Donor on Average

\$9,292
Annual Charity Care
Provided Per Client
on Average

\$33.6K
Raised thru
Online Giving



- Rosetta Jackson

When James (my son) comes to visit with me, James has his own way of telling time. After a while he'll say 'Go to St. Charles...go to Emmaus...' which means 'I've had my visit with you mom, and I'm ready to go home.' He considers Emmaus home now and that's ok. "



|Celebrating 125 Years Today

On July 2, Emmaus was founded in Marthasville, MO.

On July 5 the very first client moved in from New Orleans.

On July 11 the first female Emmaus client moved in.

70 clients are still served in the greater Marthasville area today.

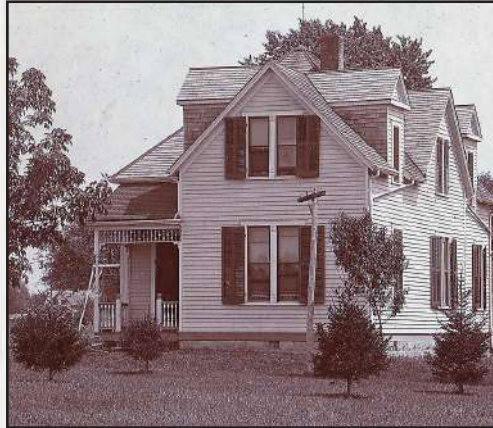

Emmaus expanded and opened its St. Charles campus to meet the vast need for services to people with developmental disabilities closer to St. Louis.

Today, 200 clients are still served in St. Charles and St. Louis area.

The Emmaus Messenger had been published in German until an English column was added in 1909.

Every issue of the Messenger since has been bound and preserved.

The Messenger continues to be delivered each Fall, Winter and Summer.

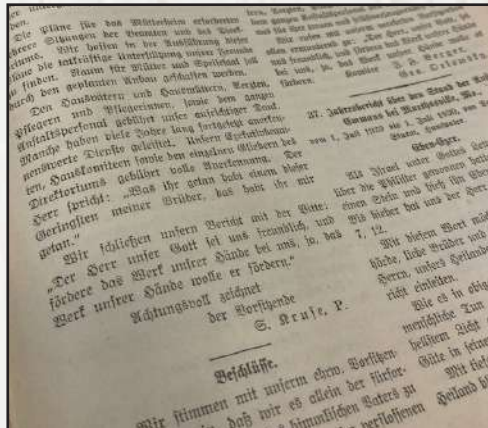

The 19th Amendment to the Constitution was ratified in August, just in time for 11 Emmaus women to vote for their very first time at the general election in November.

"Judging from the response heard after the votes were in, most were on the winning side."

Today, many clients vote and have been visited by local legislators.

By 1939, Emmaus had a 27% population increase over the previous decade.

Planning began for more construction, including a day-room and occupational therapy building with a laundry area.

Today Emmaus serves more than 80 community homes.

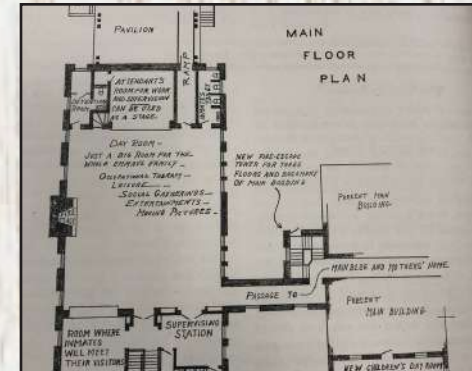

1893

1901

1909

1920

1939



Emmaus opened Russell House, the former St. Marcus UCC parsonage within St. Louis city.

This was the first time Emmaus provided services to residents off of either of their campuses and it served as home for six women.

Last year Emmaus opened 4 new homes.



Received the first 3-year CARF (Commission on Accreditation of Rehabilitation Facilities) accreditation.

This indicates Emmaus's "dedication and commitment to improve the quality of lives of people with disabilities" every 3 years since 1992.

Founded EmmausLink (formerly known as LEADD).

The program offers continuing educational opportunities. Taught by experts, courses are designed to provide life-enhancing experiences in an educational and social environment, promote growth opportunities and challenge the abilities of individuals who desire to live and work as independently as possible.

EmmausLink expanded into Warren County last year.



As we continue to expand our the depth and reach of our services, our mission remains clear: to provide the highest quality supportive care with a continued focus on our faith based tradition.

We are committed to preserving our mission for many generations to come.

1968

1985

1992

2004



Celebrating Clients

Counting on Harold

Harold is not sure how many years he has covered the altar cloths, changed the hymn board, closed the church, and carried the offering to the office after services. For the past years, the Good Samaritans (Emmaus residents* who volunteer to help their community) have thoroughly cleaned the Chapel each week. Five or six persons usually spend Thursday mornings dusting, vacuuming, and straightening up.

Like many, Harold highly values his contacts with people outside of Emmaus. While he has few living relatives, there are some very special people who help brighten his life. He looks forward to visits, cards, letters and gifts from his sponsors – the Married Couples Group of St. Johns UCC, Brighton Illinois. This very personal contact fills a real need and tells Harold that someone really cares.

*Dependable, Warm,
Friendly, Willing*

–Words that give you a clue to how Harold is thought of by the Emmaus community and others.



– Amended from the Emmaus Messenger, 1983

A Place for Peter

For Linda Mueller, everything regarding the birth of her son, Peter, felt just like it did when she had her little girl. Her son was born within just a few hours at the hospital. Everything was perfect.

However, as he grew up, Peter began missing milestones, especially in speech. Around age 3, Linda consulted specialists regarding Peter's development, but found no clear diagnosis. Peter has been labeled many things during his life: Learning Impaired, Behavior Impaired, Developmentally Disabled, signs of Autism, Asperger's. At the end of the day, Linda came to terms with the fact that, with or without a definitive diagnosis or label, Peter was simply, Peter.

Fast forward to when Peter began his adult life. It became clear that society was not designed to fit some of Peter's characteristics. For example, Peter's employer, Steak & Shake wanted to give him more hours since he was a great dishwasher, but being the regimented person he is, he declined. Oprah aired at 3pm and he couldn't miss it. Peter pays close attention to time. If you say you'll be there at 4 and don't show until 4:02, Peter will call you late and will be upset that you are "late."

Peter was living at home, but Linda started exploring different living options that would support Peter to be successful in a more independent setting. She found the system intimidating and learned that she couldn't give up and had to continue to pursue all options. She kept getting told Peter was "high functioning" and required minimal hours.

During this time, Peter encountered a lot of trauma that affects who he is today. Tragically, Peter witnessed his father suffer a fatal heart attack. When he moved out for the first time into an apartment, there was

not adequate staff support and Peter's roommate threatened him with a knife.

The effects of these traumas caused Peter to feel angry and begin acting out. Peter was kicked out of a few apartments as a result. Linda's background was in correctional facilities and recognized that the path her son was on was a downward spiral. People even began noticing how stressed Linda had become at work. A coworker pointed her in the direction of Emmaus.

"Emmaus saved Peter's life," says Linda. "We looked at Marthasville and discovered that Emmaus had been operating for years and had a wonderful reputation. I was relieved after being diagnosed with breast cancer. It felt like time was running out for me to find a safe solution for Peter."

Living at Emmaus brought something different to the table. When something was supposed to work on paper, but in reality, did not, Emmaus made adjustments to fit Peter's needs. One Emmaus team member in particular worked one-on-one with Peter to highlight his strengths, and really express trust and love. Peter was gaining independence and his anger subsided. At Emmaus, Peter was safe, secure and blooming.

Peter spent 12 years in Marthasville. "Then one day I received a phone call that made me sick to my stomach," says Linda. "Emmaus started talking about transitioning away from campus [into community homes]. Every memory of being displaced from apartments, all the hurt, and all the anger, came rushing over me."

After the realization of the announcement set in, Linda decided to take a different approach. She wanted Peter to be one of the first people off the campus. Emmaus Client Services Director Laura Davis was put in charge of the transition. She knew Peter from years before as a



case worker. Linda had incredible trust in her. They came together as a group to begin discussing the process.

They found a home in Wright City and put a plan in effect. Before moving in, Peter visited the home many times. Sometimes he brought lunch with his housemates and they were able to pick out paint colors for their bedrooms. On move-in day, Laura coordinated people to hookup Peter's TV and have everything ready that day.

Linda wanted to know how she could help. "I bought a kitchen table and will never forget dropping it off. The neighbor across the street came over and asked who was moving in. Not wanting to 'hide' anything, I explained about my son, Emmaus and his roommates. The neighbor started hugging me and assured me that he would be fine.



She gave me information about the church she belonged to and told me she had been an aide for a special needs student at a local school. I was so overwhelmed by her reaction and kindness, that I started crying – so relieved that they would be accepted."

Peter's neighbors attended an open house and are very welcoming to Peter and his housemates. One neighbor even dropped off Christmas cookies and visits with her grandkids.

Peter is part of his community. He was ignored in big cities, but in this rural setting, people know him. He volunteers with Meals on Wheels, attends a local church (Sunrise), chats with folks over coffee, attends EmmausLink classes for continuing education, participates in Special Olympics, goes bowling, rides



at Exceptional Equestrians, reads the newspaper, plays golf, looks for different social activities and much more. He even traveled to Colorado this summer.

Linda believes his transition has been successful due to the support and care he and his housemates receive from staff.

"Peter has found a purpose. People have been trying to help him all his life, but now we found that Peter is the helper. He is a cheerleader for his housemates. It's really working out. I keep waiting for the honeymoon period to end, but since moving in two years ago, it hasn't. His medications have been lowered and he's matured because of the security, safety and love he continues to experience at Emmaus. Now at 45 years old, Peter's individuality continues to impress me."

49,214

Client Outings
for personal enjoyment or leisure

10

New Clients Welcomed

279

Participants in EmmausLink



– Jennifer, Cynthia, Kaja



Thank You

*Thank you for celebrating our rich history & legacy in our community –
we are blessed with tremendous support in our critical mission
to enrich the lives of people with developmental disabilities.*

Visit **www.emmaushomes.org** to continue supporting Emmaus,
through work, volunteerism, donating or simply sharing our story.

Celebrating Donors

Emmaus' average cost to provide services for our clients is about \$303 per day. Emmaus relies on the support of our community, churches, donors and volunteers to help provide quality services for our clients. State and federal funds cover approximately 85% of Emmaus' service costs. Contributions help to cover the remaining costs, which add up to more than \$2.5 million per year.

We sincerely thank the following donors for their generous support of our mission in 2018. We have made every effort to acknowledge each of our donors with accuracy. However, if we are in error, please contact the Development Office at 636.534.5218 to make a correction.

The Carl Becker Society **\$10,000 & Up**

Mr. & Mrs. Norman Eaker
Mr. & Mrs. Joe C. Jurgensmeyer
Miss Alma Reitz
Mary & William Stewart Fund
at the YouthBridge
Community Foundation

The Heinrich & Christina **Nienkamp Society** **\$5,000 - \$9,999**

Mr. & Mrs. James Lester
Mr. & Mrs. Arthur E. Lottes III
Mrs. Lois L. Puchta Kruse
Mr. & Mrs. William A Sievers

The Rev. G Niebuhr Society **\$2,500 - \$4,999**

Mr. & Mrs. Michael Clark
Mr. Max Lindauer
Mr. & Mrs. Edward A. Lybarger, Jr.
Mr. & Mrs. Harold Schaeffer

The Emma Brune Society **\$1,000 - \$2,499**

Anonymous Fund of the Nebraska
Community Foundation
Ms. Chris Adams
Mr. & Mrs. Thomas A. Berutti
Mr. & Mrs. James P. Bovier
Rev. Cindy Bumb
Mr. & Mrs. Wayne W. Clark
Mr. & Mrs. Keith F. Cooper
Mr. & Mrs. Kevin Drosch
Mr. & Mrs. Delbert L. Grover
Mr. Jean P Haberichter
Ms. Claire M. Haldan
Mr. & Mrs. David F. Hayden
Mr. & Mrs. John Hefelee
Mr. & Mrs. Jon Holt
Mrs. Cynthia B. Howland
Rev. Donald I. Kaufman
Mrs. Lisa Drier Key
Mr. & Mrs. Mel Kohr
Mr. & Mrs. Dave Kramer
Ms. Martha Kratzer
Mr. Ken Lannen
Mr. J. Stoner Lichty, Jr.
Mr. & Mrs. Thomas J. Lindskog
Keith & Erin Linnenbringer
Margaret L. Sheldon Family Trust

Mr. & Mrs. Jim McKee
Mr. & Mrs. Kevin Moehring
Ms. Michelle Peters
Mr. & Mrs. Daryl Rhodes
Mr. & Mrs. Robert A. Schuette
Sheldon Family Trust
Mr. & Mrs. Steven R. Stout
Ms. Louise M. Waller
Mr. & Mrs. Wayne H. Wilke
Mr. & Mrs. Charles Winscott
Mr. & Mrs. Ken C. Ziegler
Rev. Dr. & Mrs. Richard S. Zuch

The Stanley Wilke Society **\$500 - \$999**

Anonymous
Mr. Rudy D. Beck
Mr. & Mrs. Anthony DeJohn
Ms. Barbara Blair Drey
Mr. Keith Ebker
Mrs. Linda Edmonson
Mr. & Mrs. Charles E. Ekstrom
Mrs. Mary Eschbach
Mrs. Ann Ficken
Mrs. Pat Foster
Mr. & Mrs. Louis S Garidel
Mr. & Mrs. Bill Harding

Mrs. Grace Harmon
Mr. & Mrs. Brandon Hays
Mrs. Karen R. Homyk
Mr. Izek Jasper
Ms. Soran Lee
Mrs. Ethel Mangold
Mr. & Mrs. Robert H. Mayer
Rev. Dr. James & Ruth Mennerick
Mr. & Mrs. Bob Merrigan
Mrs. Elizabeth Meyerpeter-Shrum
Mr. & Mrs. Roy Mueller
Mr. & Mrs. James (Shauna) O'Toole
Mr. Evan Owens
Mr. & Mrs. Vernon Prinster
Mr. & Mrs. Jeffrey L. Ray
Mr. & Mrs. Albert Schlueter
Mr. & Mrs. Henning Schulzrinne
Miss Roberta Schweisguth
Mrs. Kathryn Smallen
Mrs. Ashley Viehmann Milam
Mrs. Betty Vollmar
Mr. & Mrs. Christopher Wagner
Mrs. Mary Nina Wagner
Mr. & Mrs. Jonathan Wilke
Mr. & Mrs. James R. Willman
Judge & Mrs. Gael D. Wood

The Bettex-Koch Society **Under \$499**

Anonymous
Anonymous Give STL Day
Mr. & Mrs. Phil Ahern
Mr. & Mrs. Douglas E. Albrecht
Mr. Gilbert Ambrow
Mrs. Linda Amrhein
Mr. & Mrs. Steven Amrhein
Mrs. Doreen Anderson
Mr. Michael Anderson
Rev. & Mrs. Robert G. Anderson
Mr. & Mrs. Timothy P. Anderson
Ms. Marjorie K. Andrasko
Mrs. Julie Andrews
Mrs. Ruth Andris
Mrs. Mari-Anne Antweiler
Ms. Allison Arms
Mr. & Mrs. Gary Arthur
Rev. Andrea Asselmeier
Ms. Sumita Aurora
Mr. & Mrs. Harold J. Baker
Mr. & Mrs. Jack Baldwin
Mr. & Mrs. Derrick Ballenger
Lt. Col. & Mrs. Merrill Ballenger
Mr. & Mrs. Howard B. Baltz
Rev. & Mrs. Jim Barnes
Mrs. Cynthia Barry

The Bettex-Koch Society
Under \$499 cont.

Rev. & Mrs. Dale Bartels
 Rev. Jack Batten
 Mrs. Ebony Battle
 Mr. Gerald J. Bayer
 Mr. Al Beamer
 Mr. & Mrs. Willis Beauchamp, Jr.
 Mr. & Mrs. Harlan Beckemeyer
 Mr. & Mrs. Emmett Becker
 Rev. Dr. Gene A. Becker
 Mrs. Geraldine Becker
 Mrs. Hettie Becker
 Ms. Rose M. Becker
 Rev. James P. Beecken
 Mr. Tom Beers
 Mr. Josh Beezley
 Mrs. Ruth Behle
 Ms. Marjorie Beiser
 Mr. George H Bell
 Ms. Susan Y Bell
 Mr. & Mrs. Thomas Bell
 Dr. & Mrs. Laurence Bellon
 Mr. & Mrs. Tom Benney
 Mr. & Mrs. Thomas G Berg
 Mrs. Denise Bickel
 Mr. Steve Bierbaum
 Mr. & Mrs. Lawrence W. Bierman
 Mr. & Mrs. Loren Birnbaum
 Rev. & Mrs. Raymond Bizer
 Mr. & Mrs. Robert E. Bizer
 Mr. Eli Blavin
 Mr. John L Block
 Mr. & Mrs. Richard J. Bloesch
 Mr. & Mrs. Ken H. Blumer
 Mr. & Mrs. Steve Bochantin
 Mr. Joshua Bonstead
 Mrs. Nadine Boon & Mr. Fraser Leonard
 Ms. Brandi Bowers
 Mr. & Mrs. Norman Braksick
 Ms. Adrienne Brandt
 Mr. & Mrs. Gene Brantley
 Dr. & Mrs. James B. Breckinridge

Mr. & Mrs. Gerry Brennan
 Mrs. Shirley Brethauer
 Mr. & Mrs. J. Roger Brown
 Mr. & Mrs. Seth Brown
 Mr. & Mrs. Greg Brunts
 Mr. Terry Bryant
 Mr. & Mrs. John Buchheit
 Ms. Dorothy J. Buddecke
 Mr. & Mrs. Bill Burchett
 Ms. Jeanine Burhop
 Mr. & Mrs. Earl F. Burkhardt
 Ms. Cindy Burrows
 Mr. & Mrs. Randal Cameron
 Ms. Candyce K Canfield
 Mr. & Mrs. Brian Capar
 Mr. & Mrs. Jeffrey Carley
 Mrs. Nancy Carman
 Ms. Toni Carton
 Ms. Carol F. Carvely
 Ms. Susan Casnocha
 Mr. & Mrs. Donald H. Castillon
 Mr. & Mrs. Gerald Chase
 Mr. & Mrs. Gerald Chaskelson
 Mr. & Mrs. Robert W. Chism, Jr.
 Mr. & Mrs. John F Clark
 Mr. & Mrs. William G. Cocos, Jr.
 Mr. & Mrs. Stephen M. Collier
 Mr. & Mrs. Sonny Collison
 Mrs. Virginia L. Conlee
 Mr. & Mrs. Kenneth Conley
 Mr. & Mrs. Olin K Conley
 Mr. & Mrs. William F. Connor
 Mr. & Mrs. Osmond Conrad
 Mrs. Ida Cookson
 Mr. Lorin W. Cope
 Mr. & Mrs. Jeff Copeland
 Mr. Robert J. Coppinger
 Mr. & Mrs. James Costello
 Mr. & Mrs. William G. Cotner
 Mr. & Mrs. Dennis L. Courtois
 Mr. & Mrs. Timothy Cox
 Ms. Rhonda Creasy Aiello
 Ms. Angie Creek
 Mr. & Mrs. Dorian D. Crismon
 Mrs. Noel Cubbage

Mr. & Mrs. Tim Curran
 Mr. & Mrs. R. A. Cutright
 Ms. Margaret L. Davenport
 Ms. Laura Davis
 Mr. & Mrs. Nicholas F. Davis
 Ms. Yvette Davis
 Mrs. Donna J. Debney
 Rev. & Mrs. James G. Deitz
 Mr. John T Delanty
 Mrs. Marie Delgman
 Mrs. Jane Dick
 Ms. Sandra Dickey
 Mrs. Carol Marie Diederich
 Mr. & Mrs. Jim Diederich
 Mr. & Mrs. Calvin Dierberg
 Mr. & Mrs. Douglas E Dillard
 Mr. & Mrs. Charles Dittmer
 Mrs. Marjorie Donze
 Mr. & Mrs. Christopher Dowling
 Mr. & Mrs. Arthur J. Downey
 Ms. Facesby Drea
 Mr. & Mrs. Leo P. Dressel
 Mrs. Betty Ann Drier
 Mrs. Lola Droge
 Mrs. LaVerne Dubbert
 Mr. & Mrs. Gerald Dueill
 Mrs. Huguette Duff
 Mrs. Victoria Jean Dunlap
 Ms. Wanda Dunlap
 Mr. & Mrs. Earnest Durham
 Mr. & Mrs. John J. Dwyer, Jr.
 Mrs. Florence Ebert
 Mr. & Mrs. Craig Eckert
 Mr. & Mrs. John Eckert
 Ms. Patricia M. Edgeworth
 Mr. & Mrs. David Edgington
 Ms. Joyce Edinger
 Ms. Kathleen Egan
 Mr. & Mrs. Will Elder & Gertrude Newman
 Ms. Karen Emge
 Mrs. Sally Enderle
 Rev. & Mrs. A. Gayle Engel
 Mrs. Mary Engelbrecht
 Dr. Calvin E. Engelmann

Mrs. Viola Engemann
 Mr. & Mrs. Charles T. Erickson
 Ms. Theresa P Essner
 Ms. Ciera Estell
 Ms. Debbie Evers
 Mr. & Mrs. Roy E. Evers
 Mr. & Mrs. Roger Fagerberg
 Mrs. Janice Farmer
 Mr. & Mrs. Patrick Farrell
 Mr. & Mrs. Mark Feldmann
 Mr. Eric Fellingner
 Mrs. Erika Fellingner
 Mr. & Mrs. Thomas E. Fenner
 Mrs. Joan Ferbrache
 Mr. Robert Ferguson
 Ms. Susan Fiehler
 Mr. LeRoy Finke
 Mrs. Eva Marie Fitz
 Ms. Kathleen Flynn
 Rev. & Mrs. Robert Fread
 Mrs. Sheila N. Fredrick
 Mr. & Mrs. Edward Fritsch
 Mr. & Mrs. James Fritsch
 Mr. & Mrs. Manfred Fuchs
 Mr. & Mrs. William Fuest
 Mrs. Krista Futch
 Ms. Karen E. Gaertner
 Ms. Abigail George
 Mr. & Mrs. James P. Gephardt
 Mr. Lincoln Gray
 Mr. Paul Gray
 Ms. Jazzmine Green
 Mr. & Mrs. Paul Greenberger
 Mr. & Mrs. Craig Gregory
 Mr. & Mrs. Bob Greiwe
 Mr. & Mrs. Roger Grob
 Mr. Jonathan Grobstein
 Ms. Hallie Groff
 Mr. & Mrs. Charles Gross
 Mr. & Mrs. Steve E. Grote
 Mr. & Mrs. Harry E. Grupe
 Mrs. Betty Gschwind
 Ms. Julie Gust
 Mrs. Rosalie Hahn
 Mr. & Mrs. Jim Hafer

Mr. & Mrs. Barry L. Haith
 Mrs. Frances Halmich
 Mrs. Beverly Hanson
 Mrs. Grace Harmon
 Mr. Glen Harper
 Mrs. Gina Hartman
 Mr. & Mrs. Larry Hartman
 Mr. Walter Hatcher
 Ms. Stacey Hawkins
 Mr. & Mrs. Marvin Hays
 Mr. Kevin Heard
 Mr. Steve Hebel
 Mrs. Delores Hedeman
 Mrs. Albert Heimbaugh
 Mr. James K. Heisel
 Mr. & Mrs. David Helldoerfer
 Mr. & Mrs. Dave Hendel
 Mr. & Mrs. Marvin O. Herpel
 Mr. & Mrs. Elmer Hertlein
 Diane and Michael Heuvelman
 Ms. Lisa Highfill
 Mrs. Carolyn Hileman
 Mrs. Marcia Hill
 Mr. J. Daniel Hoag
 Ms. Eleanor Hoefle
 Ms. Carolyn L. Hoerr
 Mr. & Mrs. James Hoerstkamp
 Mr. & Mrs. Ray Hoffstetter
 Mrs. Rose Hogan
 Mr. Frank Holmes
 Mr. & Mrs. Douglas A. Holtmeyer
 Mr. & Mrs. Ronald Hora
 Rev. Roger V. Horn
 Mrs. Melba Houston
 Mr. & Mrs. Jacob Huber
 Mr. & Mrs. David Hucker
 Mrs. Jeanette Huffman
 Mr. & Mrs. Chris Ingalls
 Mr. & Mrs. Thomas Jablonski
 Mr. Bret Jackson
 Ms. Rosetta F. Jackson
 Mr. & Mrs. Robert L. James
 Mr. & Mrs. Bradley Jandro
 Mrs. Carol J. Jaudes
 Mrs. Theresa Jeevanjee

Ms. Sherry Jehling
 Ms. Teresa Jehling
 Mr. & Mrs. Rich Jennings
 Mr. & Mrs. Gerald Johanpeter
 Mrs. Marlene A. Johnsen
 Marlene Johnson
 Mr. George F. Jokerst
 Ms. Elizabeth Jones
 Mr. Delwin H. Juedemann
 Mrs. Viola Jurgensmeyer
 Mr. & Mrs. James L. Kaiser
 Mr. Jeffrey Keiser
 Mr. Josh Kergosien
 Mr. Michael Kergosien
 Mr. Randy Key
 Mr. Jeffrey Kies
 Mr. Thomas Kimani
 Mrs. Linda King
 Mrs. Melissa Kirsch
 Rev. & Mrs. Armin F. Klemme
 Rev. & Mrs. John Klueter
 Rev. & Mrs. David F. Kniker
 Mr. & Mrs. Edward R. Knop
 Mr. Eugene Knopik
 Rev. & Mrs. Erwin R. Koch
 Mr. Mark Koenig
 Mr. Gene Koepke
 Ms. Connie Koontz
 Ms. Christine Kopec
 Dr. Stuart A. Kornfeld
 Mr. & Mrs. Gene W. Kotthoff
 Ms. Kathy Krahman
 Ms. Tami Kramer
 Mrs. Helen W. Kronmueller
 Mr. Richard J. Krull
 Mrs. Phyllis Kuhns
 Mr. Stephen Kummer
 Mr. & Mrs. Bobby Kurtzeborn
 Ms. Sinie LaCour
 Mrs. Darlie Lamb
 Mrs. Gail Lauer
 Ms. Charlotte Lehmann
 Mr. & Mrs. Eldon C. Leiter, Jr.
 Mr. & Mrs. Adam Liberto
 Mr. Richard Liekweg

Mr. & Mrs. Earl J. Lischer
 Mr. Jeffrey Litterst
 Mr. & Mrs. Jack Litzinger
 Mrs. Milton E. Litzinger
 Mr. Timothy Logan
 Mrs. Gwendolyn Lohmann
 Mr. & Mrs. Rene Lusser
 Mrs. Eilene Lyons
 Mr. & Mrs. Walter C. Maag, Jr.
 Rev. Sharon K. Maddox
 Mr. & Mrs. Melvin L. Maire
 Mr. & Mrs. Leo M. Malone
 Ms. Lyann Malter
 Mr. Paul D. Marks
 Ms. Lisa Marquart
 Mr. & Mrs. David Martin
 Mr. & Mrs. James C. Martin
 Mrs. Joetta Martin
 Mr. Patrick Martin
 Mr. & Mrs. Thomas J. Martin
 Mr. & Mrs. Mark Martinez
 Mr. & Mrs. George Mayers
 Mrs. Elizabeth McBroom
 Ms. Nyisha McClain
 Mrs. Vanette McConahey
 Mrs. Betty McCormick
 Mr. & Mrs. Craig McCormick
 Mrs. Marcella McDonald
 Mr. Chris McGrail
 Ms. Phyllis McIntosh
 Mr. & Mrs. David McNamee
 Mr. & Mrs. Michael Meagher
 Mr. Spencer Medley
 Ms. Vida Mehrhoff
 Rev. Robert C. Meissner
 Ms. Michelle Melton
 Mr. Timothy Mercurio
 Ms. Lisa Merenda
 Ms. Mona Mergenthal
 Ms. Stefanie Messmer
 Mrs. Bonnie S. Metzger
 Mrs. Harold Meyer
 Mr. & Mrs. Norman Meyer
 Mr. & Mrs. Paul R. Meyer
 Mrs. Shirley Meyer

Mr. & Mrs. Stuart Meyer
 Mr. & Mrs. Shawn Meyerpeter
 Mr. & Mrs. Robert A. Miller
 Ms. Roberta D. Miller
 Mrs. Carol Mills
 Charles & Miriam Mittler
 Mr. Michael C. Mittler
 Mr. & Mrs. Michael Moellering
 Ms. Ruby L. Moon
 Ms. Sharon J. Mooney
 Ms. Sharan Moore
 Mrs. Kathy Moreland
 Mrs. Ruth Hubert Morris
 Ms. Cheryl Morrow
 Mr. Larry Gene Morton
 Mr. & Mrs. Donald Moser
 Mr. & Mrs. William F. Mueller
 Mr. & Mrs. Eugene Naumann
 Mr. Robert E. Naumann
 Mr. & Mrs. Roy Mueller
 Ms. Jodean Newell
 Ms. Annette L. Newquist
 Mr. & Mrs. J. Daniel Nickel
 Mr. & Mrs. David Nienkamp
 Ms. Malinda M. Niermann
 Mr. & Mrs. Keith Noelke
 Mrs. Dorothy Noiro
 Rev. & Mrs. Carleton E. Norton
 Ms. Brenda Novel
 Mr. & Mrs. John Oates
 Rev. & Mrs. Richard Oberle
 Mr. & Mrs. James Obermark
 Mrs. Glenda Obholz
 Mrs. Marion Oelze
 Mrs. Laverne Oetting
 Mr. & Mrs. Arthur Oldenburg
 Mr. Andrew Olree
 Ms. Olufunke Oluyemi
 Mr. & Mrs. Leward H. Osthoff
 Mr. & Mrs. Jim (Mary) O'Toole
 Mrs. Margaret Ottersbach
 Mr. & Mrs. Bill Parcel
 Mr. & Mrs. Patrick Patton
 Mr. David G. Paulton
 Mrs. Norma Pepmeier

Mr. & Mrs. Derrold Petersmeyer
 Mr. & Mrs. Louis R. Pinkas
 Mr. & Mrs. Richard Pisarkiewicz
 Ms. Margaret Poggemeier
 Mr. & Mrs. John Poindexter
 Ms. Paige Polacek
 Mr. & Mrs. Thomas Ponche
 Ms. Laura Populin
 Mr. & Mrs. Tom Powers
 Mr. & Mrs. Albert J. Prinster
 Mr. & Mrs. Bill Prinster
 Mr. & Mrs. Greg Pritchett
 Mr. & Mrs. Elmer Puettmann
 Mrs. Betty Pundmann
 Mr. Nick Quargnenti
 Mr. & Mrs. Kenneth Rahe
 Mr. & Mrs. Carl E. Ramey
 Mr. & Mrs. Leo Range
 Mrs. Deborah Rathert
 Mrs. Linda Rau
 Mr. & Mrs. Ric Redtman
 Ms. Cindy Reed & Mr. Scott Wiley
 Ms. Janet L. Reed
 Ms. Lisa Reed
 Ms. Michelle Reeves
 Mr. & Mrs. Owen Reinert
 Mr. & Mrs. Ernst Reinholdt
 Mr. & Mrs. Frank Remington
 Rev. & Mrs. Levering Reynolds III
 Ms. Romana Rice
 Mrs. Carolyn K. Richert
 Mr. & Mrs. J. R. Ricker
 Mr. & Mrs. Lloyd Riney
 Ms. Patricia Ring
 Ms. Kathleen Rippelmeyer
 Mrs. Beverly River
 Mr. & Mrs. Bob River
 Dr. Edward A. Roach
 Mr. & Mrs. Fred Robinson
 Mrs. Janet Rock
 Mr. & Mrs. James R. Roesch
 Mr. Jimmy Rogers
 Ms. Linda Ronan
 Mr. & Mrs. Gary Ruhbeck
 Mr. & Mrs. Scott Rupp

Mr. David Russell
 Mr. & Mrs. Mike Ryan
 Mr. Tim Ryan
 Ms. Ellen Ryder
 Rev. & Mrs. Donald S. Sabbert
 Mr. & Mrs. Calvin V. Sailer
 Ms. Nadezda Saunders
 Mrs. Sally Schaefer
 Mr. & Mrs. Steve Schaeffer
 Mrs. Tammy Schaeffer
 Mr. & Mrs. Craig Schannuth
 Mr. & Mrs. Donald Schappe
 Mr. & Mrs. Ardell J. Schelich
 Mrs. Nina Schladerbach
 Mrs. Sue Schlanker
 Mr. David Schlichter
 Rev. Arlan & Sharon Schlundt
 Rev. & Mrs. Eldon Schmidt
 Mr. & Mrs. Glenn Schmidt
 Mr. & Mrs. Dale G. Schmuke
 Mrs. Marjorie Schoene
 Rev. & Mrs. George Schowalter
 Mr. & Mrs. James H. Schrader
 Mrs. Carol Schroedel
 Ms. Ruth Schroeder
 Mr. & Mrs. Richard Schrupf
 Mr. & Mrs. Neil J. Schulte
 Ms. Connie L. Schuman
 Rev. & Mrs. William H. Schwab
 Mr. John W. Schwenck
 Mrs. JoAnn Scott
 Mr. & Mrs. David J. Seithel
 Mr. & Mrs. Gerard T. Seliga
 Ms. Mary Suzanne Sewell
 Mr. & Mrs. Alfred D. Shaplin
 Ms. Charlotte Shelburne
 Mrs. Gail Shepard
 Ms. Linda Shine
 Mr. & Mrs. Paul Sill
 Mrs. Sharon Silver
 Mrs. Florence Simonson
 Mr. & Mrs. Richard J. Skelton
 Mr. & Mrs. Will Skowyra
 Ms. Kari Skrivan
 Mr. & Mrs. Kurt Sliefert

The Bettex-Koch Society
Under \$499 cont.

Mr. Richard Small
 Mrs. Sarann Smeaton
 Mrs. Beverly Smith
 Mr. & Mrs. Tom Sonderegger
 Mr. Kevin C. Sowell
 Mr. Don A. Speck
 Mr. Jason Spencer
 Mrs. Pearl Spies
 Mrs. June S Spillman
 Ms. Ellen Staples
 Mr. Frank E. Stas
 Mr. & Mrs. Donald L. Stegen
 Mr. & Mrs. David A. Steiner
 Mr. & Mrs. Robert Stelmach
 Rev. & Mrs. Herbert Stemler
 Mr. & Mrs. Wesley Stemme
 Mr. & Mrs. David C. Stephens
 Mrs. ShuShon Stevenson-Morrow
 Mrs. Kristen Stewart
 Mr. & Mrs. Werner C. Stichling
 Mr. & Mrs. Donald G. Storck
 Mrs. Pamela A. Stout
 Avon Stovall
 Mr. & Mrs. James Straatmann
 Ms. Sandra Street
 Mrs. Susan Strickland
 Mr. Frank H. Stroot
 Mr. & Mrs. Donald A. Stumpf
 Mr. William Sturm & Ms. Ann Samani
 Mr. Ronnie Stutz
 Ms. Denise Style
 Mr. Josh Sussman
 Mr. Jeff Tacina
 Ms. Sharon Tellmann
 Marvis & Bruce Templer
 Mr. & Mrs. John Tesluk, Jr.
 Mr. John W. Thies, Jr.
 Mrs. Kolene Thies
 Ms. Marlene Thoenes & Henry Fick
 Mr. & Mrs. Dennis Thornhill
 Ms. Mary Tillman
 Mr. & Mrs. Robert G. Tobben

Mr. & Mrs. Robert H Tucker
 Mr. & Mrs. Scott Tuhro
 Mrs. Kathy S. Ury
 Ms. Louise Veith
 Ms. Judith Venard
 Mr. & Mrs. Frank Vullo
 Ms. Sherry Waitz
 Ms. Pamela Waligorski
 Mr. & Mrs. Stephen Walkenbach
 Mrs. Kristen Wamsley
 Mr. & Mrs. Leland Ward
 Dr. & Mrs. Donald L. Weaver
 Mr. & Mrs. Rick Weaver
 Mrs. Karen Weekley
 Mr. & Mrs. Ross Wehling
 Rev. & Mrs. Fred Wehrenberg
 Mr. & Mrs. Wayne E. Weinrich
 Ms. Mary Weiss
 Mr. & Mrs. Douglas A. Welch
 Ms. Sandra Welsch
 Mr. & Mrs. Michael P. Wente
 Rev. & Mrs. Roger Wentz
 Mrs. Barbara Werges
 Mr. Carl Wermuth
 Mr. & Mrs. Wilbert Wernecke
 Mr. Warren R. Werner
 Mrs. Esther Westermeyer
 Ms. Pat Wetzol
 Mrs. Kathleen A. Wiesehan
 Mr. John Wilcox
 Mr. & Mrs. Frederick W. Wilke
 Mr. & Mrs. Alvin Wilkening
 Mr. & Mrs. Daniel Wilkins
 Rev. John H. Will
 Mrs. Kari Williams
 Ms. Marian C Williams
 Ms. Lynne Winkelmann
 Ms. Mary Ann Wippermann
 Mr. & Mrs. Kenneth J. Wisniewski
 Ms. Phyllis Wittig
 Mr. & Mrs. Charles Wolfersberger
 Ms. Rebecca Woltermath
 Ms. Nancy Wyhs
 XYZ St Group/Mary Henderson
 Joyce Yost

Mr. & Mrs. Edward Young
 Mr. & Mrs. Charles A. Zelsman
 Rev. & Mrs. Arthur D. Zillgitt
 Ms. Erin Zimmermann
 Mr. & Mrs. Harold L. Zimmermann, Jr.
 Mr. & Mrs. Douglas R Zweifel

In Kind

Affordable Automotive
 All-Type Vacuum & Janitorial Supply
 Barwise Hunt Club LLC
 Bayou Devieu
 BCI & BCI Packaging
 Bell Bend Farms
 Bethmann Farm & Club
 Carmen Bumgarner
 Cabela's
 Calvary UCC, Overland
 Rev. Kevin Cameron & Family
 Charlie's Farm & Home True Value
 Janet Ramey Chavers
 Craftsmen Industries
 DDRB of St. Charles County
 Dive Bomb Industries
 Dr. Pepper Snapple Group
 Duck's Grille & Bar
 Ducks Unlimited
 Duggan Contracting Corporation
 Dyken Farm
 El Agave Mexican Restaurant -
 Elm St., St. Charles
 Elmer's Tavern
 Ethyl's Smokehouse
 Farrell & Martin Law Firm
 Mrs. Denise Gibbs
 Greig & Barb Gladden
 Glazer's
 Good Shepherd UCC, St. Charles, MO
 Gun Dog Supply
 Hackmann Lumber And Home Center
 Hall Kennels
 Mr. Christopher Hartnett
 Heaven Sent St. Louis Inc
 Steve & Julie Hecht

Hobo's
 Sharon Holtmeyer & Family
 Hope UCC, St. Louis
 Hubbard Radio
 IGA Midtown Market
 Illini Congregational UCC,
 Warrensburg, IL
 J. Hair Gallery
 Kathy Maisel
 K & R Market
 Pat Jett
 Ms. Gretchen Kimble
 Mr. John Kopmann
 Krey Distributing Company
 Liz Nails
 Longhorn Steakhouse, St. Peters
 Massa's
 Virginia Mattera
 MOMarsh
 Moudy's Bar & Grill
 Joan Nohova
 Papa John's
 Parkway UCC, St. Louis
 Philly's Pizza
 Purdy Farms Duck Club
 Sewing & Knitting Clubs of First
 Congregational UCC,
 Waukesha, WI
 Quincy Farm & Home Supply
 Racks & Tracts
 Mrs. Janet Ramey Chavers
 Rams Ditching
 Mrs. Linda Rau
 Reckamp Farms
 Ric & Jeanne Redtmann
 Rig 'Em Right
 River City Rascals
 Betty Scherrer
 Scott's Power Equipment
 Mrs. Mae Silverberg
 Kristen Stewart
 St. Charles Community College
 St. John UCC, St. Charles
 St. John's UCC, Manchester
 St. Luke's UMC, St. Louis

St. Peter's Garage
 St. Peter's UCC, Washington
 Stitches for Life/St. Cletus Catholic
 Church, St. Charles
 Jayne Struckhoff
 Taormina's
 The Muny
 Tom James Company
 Westhoff Farm
 Westwind Farms
 Mrs. Pam Wolff
 Women's Fellowship of St. Paul's
 United UCC, Oakville
 Women's Fellowship of St. Peter's
 UCC, Inman, KS

Special Event Sponsors

All-Type Vacuum & Janitorial Supply
 Ameren
 Argent Capital Management, LLC
 Autcohome
 Bailey Law Firm, LLC
 Boehmer Bros., Inc.
 Boone Center Inc
 Botz, Deal And Company, P.C. CPA's
 Brown Smith Wallace, LLP
 Cabela's
 Caliber Cast Stone, LLC
 Cissell Mueller Construction Co.
 Countryside Carpets & Interiors, Inc.
 CSM Construction
 Dental Anesthesia Center
 Dg Partners, LLC
 Duggan Contracting Corporation
 Ellis Battery Specialists
 Enterprise Bank & Trust
 EverSpring Pharmacy
 Express Scripts
 Flynn Drilling Company
 Hackmann Brothers, Inc.
 Husch Blackwell, LLP
 Jim Trenary Motorsports, Inc.
 Krey Distributing Company
 Mr. Jim Lang

Lockton Companies
 Mark Charlton/Edward Jones
 Marshall Ford Sales, Inc.
 MTC MOM, LLC
 Nestle Purina Petcare Co.
 Ogletree Deakins
 On The Go Hauling
 Oreck Home Care
 Pitman Funeral Home, Inc.
 Quincy Farm & Home Supply
 Rams Ditching
 Rogers Comfort Systems Of St. Charles
 RubinBrown
 Saale Law Firm, LLC
 Saints Avenue Bancshares
 Summit Strategies Group
 T.R. Hughes Homes
 UMB Bank
 Upper Duck Hunting, LLC
 US Bank
 Warrenton Oil Co.
 Willbrand Grain Farms, LLC

Corporate Businesses, Organizations & Foundations

Aetna Foundation
 Amazonsmile Foundation
 Ameren UE
 Ameriprise Financial, Inc.
 Carpenters And Joiners of America
 Local #1839
 City of St. Charles
 City of St. Charles Arts & Culture
 Commission
 City of St. Charles City Council
 Corneille Law Group, LLC
 The Crawford Taylor Foundation
 Cuivre River Electric Community Trust
 Duckfest, Inc.
 East Missouri Foundation
 Echo Valley Foundation
 Ellis Battery Specialists, LLC
 Emerson Climate Technologies

Employee's Community Fund of
 Boeing St. Louis
 Enterprise Holdings Foundation
 Express Scripts Inc.
 Facebook
 Friends Foundation
 Graybar Electric Company
 Hellebusch Tool & Die
 Hodges Badge Company, Inc
 Home Builders Charitable Fund
 Husch Blackwell, LLP
 Knights of Columbus #7198
 Knights of Columbus Council # 1587
 Knights of Columbus Council #1121
 Lighting Associates Inc
 Lutheran Foundation of St. Louis
 MTC MOM, LLC
 Network for Good
 Paypal Giving Fund
 Pharma Tech Industries Community
 Chest Inc - Missouri
 Herman T. & Phenie R. Pott
 Foundation
 Remi Investments, LLC
 Rotary Club of Washington
 Schnucks Markets, Inc.
 Smith Family Foundation
 St. Charles Jaycees Junior
 Chamber of Commerce
 St. Louis Community Foundation
 U.S. Bank
 U.S. Bank Foundation
 US Trust Bank of America
 Voss Handyman Service, LLC
 Walmart Store #648
 Walmart Store #1161
 Westermeyer Ag Service, LLC
 Wm. & Betty Halliday Foundation

Housing Partners

Archdiocese of St. Louis
 Mr. & Mrs. Chris (Jennifer) Bartlett
 Ms. JoAnn Booth
 CAT Investments, LLC/

Tom Brakensiek, Jr.
 Mr. & Mrs. Phil (Sue) Finck
 JABER 1, LLC
 J.R. Properties Group, LLC/
 Jason Abernathy
 Mr. & Mrs. Edward (Angelina)
 Lybarger
 Mr. & Mrs. John (Karen) Lyons
 Marthasville Business Center, LLC
 Mrs. Mary Metts
 Mr. & Mrs. Keith (Brenda) Meyer
 MTC Mom LLC/
 Larry Schartz & Dan Schwartz

Rainbow Village
 REMI Investements, LLC/
 Tom Bruening
 Resident Management Services, Inc.
 Mr. & Mrs. Harvey (Tammy) Siem
 S-K Contractors/Shawn Myall
 Sun River Village
 Tompa, LLC
 Mr. & Mrs. Art (Cheryl) Verme
 Zigcorp Properties, LLC/Roy Ziegler

Estate Gifts

Rev. Paul Bendit
 Lester Berger
 Dr. Eugene Brockmann
 Frank & Maxine Dilling
 Mr. Joseph S. Lichty
 Marie B. Kestng
 James & Gladys H. Myles
 Helen B. Page
 Rev. John R. Thompson

Third Party Trusts

Aimee M. L. Becker Trust
 David E. S. Bernd Memorial
 Endowment Fund
 John C. Driskell Memorial Fund
 Milton Gaebler Charitable Foundation
 Henry. Halloway Irrevocable Trust
 Herbert W. Mehl Irrevocable Trust
 Ruth Rice Trust

Clarence Staake Irrevocable Trust

Matching Gifts

Bank Of America Corporation
 Matching Gifts Program
 Bectin, Dickinson & Company
 Pfizer Foundation Annual Giving
 Matching Funds
 U.S. Bank Foundation Employee
 Matching Gifts Program

Emmaus Goodwill Churches \$1000 & Up

Columbia UCC, Columbia, MO
 Evangelical Congregation of the
 Redeemer, Saint Louis, MO
 Evangelical UCC, Cape Girardeau, MO
 Faith UCC, Indianapolis, IN
 Grace Congregational UCC,
 Two Rivers, WI
 Immanuel UCC, Lafayette, IN
 Immanuel UCC, Saint Louis, MO
 Mount Tabor UCC, Saint Louis, MO
 Peace UCC, Saint Louis, MO
 Samuel UCC, Saint Louis, MO
 St. John UCC, Ballwin, MO
 St. John UCC, Saint Charles, MO
 St. Lucas UCC, Saint Louis, MO
 St. Paul Evangelical Church UCC,
 Saint Louis, MO
 St. Paul Evangelical UCC,
 Bloomingdale, IL
 St. Paul's Evangelical Church,
 Saint Louis, MO
 St. Paul's UCC, Saint Louis, MO
 St. Peters Evangelical UCC,
 Saint Louis, MO
 The First Congregational Church of
 St. Louis, MO
 Wisconsin Conference of the UCC
 Zion-St. Paul UCC, Hermann, MO

Emmaus Goodwill Churches \$500-\$999

Bethany UCC, Berger, MO
 California UCC, California, MO
 David's UCC, Kettering, OH
 Faith United Methodist Church,
 Saint Charles, MO
 First Congregational Church of
 Webster Groves, MO
 Immanuel UCC Sewing Circle,
 Saint Louis, MO
 Salem UCC, Huntingburg, IN
 St. James Evangelical Church of
 Stony Hill, New Haven, MO
 St. John UCC, Saint Clair, MO
 St. Johns Evangelical UCC,
 Saint Louis, MO
 St. John's UCC (Cappeln), Foristell, MO
 St. John's UCC, Minier, IL
 St. John's UCC/Stolpe, Hermann, MO
 St. Luke's UCC, Independence, MO
 St. Paul UCC, Hermann, MO
 St. Paul's UCC, Marthasville, MO

Emmaus Goodwill Churches Up to \$499

5050 Class Fund of St. John's UCC,
 Springfield, MO
 Alida United Parish Women,
 Chapman, KS
 Bethany UCC, Freeport, IL
 Bethel UCC, Kansas City, MO
 Calvary UCC, Saint Louis, MO
 Christ Church UCC, Saint Louis, MO
 Church of Peace Churchmen
 Brotherhood, Kewanee, IL
 Church of The Master, Florissant, MO
 Community UCC, Carbondale, KS
 Council of Health & Human Service
 Ministries (CHHSM)
 Ebenezer Stone Church UCC,
 Gerald, MO
 Epiphany UCC, Saint Louis, MO
 Faith UCC, Wentzville, MO

Emmaus Goodwill Churches Up to \$499 cont.

Faith United Methodist Women,
Saint Charles, MO
Farmersville UCC, Farmersville, OH
First Congregational Church of
Beardstown, IL
Friedens UCC, Troy, IL
Friedens UCC, Warrenton, MO
Friendship Guild of St. Peter's UCC,
Billings, MO
Fulton UCC, Fulton, MO
Grantfork UCC, Highland, IL
Homebuilder Class of Eden Church,
Muncie, IN
Illinois Conference of the UCC
Immanuel UCC Evening Circle,
Wright City, MO
Immanuel UCC, Peotone, IL
Ladies Aid of St. John's UCC-Stolpe,
Hermann, MO
Ladies of St. Paul UCC, Minonk, IL
Lay Fellowship of St. John's UCC,
Concordia, MO
Mary Queen of Peace Catholic Church,
Webster Groves, MO
Men's Fellowship of Salem UCC,
Alhambra, IL
Midland Community UCC, Sterling, KS
Nebraska Conference United Church of
Church, Lincoln, NE
Partridge Women's Fellowship,
Partridge, KS
Peace UCC, Alma, KS
Peace UCC, Merrillville, IN
Pence Endowment of Trinity UCC,
Mount Vernon, IN
Pilgrim UCC, Labadie, MO
Round Grove UCC, Lewisville, TX
Salem Evangelical UCC, Quincy, IL
Salem UCC, Alhambra, IL
Salem UCC, Higginsville, MO
St. James UCC, Morrison, MO

St. John Evangelical UCC,
Collinsville, IL
St. John UCC, Freeport, IL
St. John UCC, Granite City, IL
St. John UCC, Maeystown, IL
St. John's Chapel UCC Friendship
Circle, Springfield, MO
St. Johns Evangelical UCC - Missions
Commission, Saint Louis, MO
St. John's Mission Outreach
Committee, Mokena, IL
St. Johns UCC (Bem), Owensville, MO
St. Johns UCC Billingsville,
Boonville, MO
St. Johns UCC Brotherhood, Moro, IL
St. Johns UCC, Baldwin City, KS
St. John's UCC, Chesterfield, MO
St. Johns UCC, La Crosse, WI
St. Johns UCC, Mokena, IL
St. Jordan's UCC, Beaufort, MO
St. Martin UCC, High Ridge, MO
St. Paul UCC Women's Guild,
Belleville, IL
St. Paul UCC, Columbia, IL
St. Paul UCC, Denver, IA
St. Paul's UCC Triangle Class,
Evansville, IN
St. Paul's UCC, Freeburg, IL
St. Pauls UCC, Gerald, MO
St. Pauls UCC, Wheatland, IA
St. Peters UCC of Coupland, TX
St. Thomas UCC, Chesterfield, MO
Trinity UCC, Quincy, IL
Trinity UCC, New Lebanon, OH
Union Congregational Church,
Tavares, FL
Union of Concerned Christians of
Evangelical UCC, Cape Girardeau, MO
United Church Women, Wisner, NE
Women of Bethel UCC, Manchester, MI
Women of Immanuel UCC,
Louisville, KY
Women's Fellowship of Bethany
Church, Berger, MO

Women's Fellowship of Bethel UCC,
Nebraska City, NE
Women's Fellowship of Central UCC,
Jefferson City, MO
Women's Fellowship of Columbia UCC,
Columbia, MO
Women's Fellowship of Emanuel UCC,
Jackson, MO
Women's Fellowship of Emanuel UCC,
Weldon Spring, MO
Women's Fellowship of First
Congregational Church,
Greene, NY
Women's Fellowship of First UCC,
Clarksville, IA
Women's Fellowship of Friedens UCC,
Bern, KS
Women's Fellowship of Friedens UCC-
Brazito, Jefferson City, MO
Women's Fellowship of Huntington
Congregational Church,
Shelton, CT
Women's Fellowship of Immanuel
UCC, New Franklin, MO
Women's Fellowship of Mystic
Congregational Church,
Mystic, CT
Women's Fellowship of New Basel
UCC, Abilene, KS
Women's Fellowship of North Haven
Congregational Church,
North Haven, CT
Women's Fellowship of Peace UCC,
Walnut, IA
Women's Fellowship of Shelby
Congregational, Shelby, MI
Women's Fellowship of St. James UCC,
Morrison, MO
Women's Fellowship of St. Johns
Evangelical UCC, Saint Louis, MO
Women's Fellowship of St. John's UCC,
Griswold, IA
Women's Fellowship of St. Johns UCC,
Valmeyer, IL

Women's Fellowship of St. Johns UCC,
Waverly, IA
Women's Fellowship of St. Martins
UCC, Dittmer, MO
Women's Fellowship of St. Paul
Church, Hermann, MO
Women's Fellowship of St. Paul UCC,
Kahoka, MO
Women's Fellowship of St. Paul UCC,
Waterloo, IL
Women's Fellowship of St. Peter's
UCC, Inman, KS
Women's Fellowship of St. Peter's
UCC, Massena, IA
Women's Fellowship of St. Peter's
UCC, New Haven, MO
Women's Fellowship of Zion UCC,
Arthur, IL
Women's Fellowship of Zion United
Evangelical Church,
Wathena, KS
Women's Fellowship of Zion-St. Paul,
Hermann, MO
Women's Fellowship Redeemer
Evangelical Church,
Saint Louis, MO
Women's Fellowship United In Faith
Church of Pana, IL
Womens Guild of Christ UCC, Dupo, IL
Women's Guild of Evangelical UCC,
Highland, IL
Women's Guild of First UCC,
Marshalltown, IA
Women's Guild of Friedens Reformed
UCC, Parkston, SD
Women's Guild of Immanuel UCC,
Evergreen Park, IL
Women's Guild of Marine UCC,
Marine, IL
Women's Guild of Peace UCC,
Alma, KS
Women's Guild of Salem UCC,
Alhambra, IL
Women's Guild of St. John UCC,
Nashville, IL

Women's Guild of St. John UCC,
New Athens, IL
Women's Guild of St. John's UCC,
Fairmont, MN
Women's Guild of St. John's UCC,
Faribault, MN
Women's Guild of St. Jordan's UCC,
Beaufort, MO
Women's Guild of St. Paul UCC,
Edwardsville, IL
Women's Guild of St. Peter's UCC,
Okawville, IL
Women's Guild of Zion UCC,
Addieville, IL
Women's Guild of Zion UCC,
Junction City, KS
Zion Fellowship of Zion UCC,
Le Sueur, MN
Zion Oakfield UCC, Pacific, MO
Zion UCC, Clifton, TX
Zion UCC, Florissant, MO
Zion UCC, Lowden, IA

Thank You to Our Volunteer Groups

Academy of Sacred Heart, St. Charles
Calvary Serve Day
Calvary Hammer Heads
Christ Church UCC Confirmands, Maplewood
Church of the Shepherd, St. Charles
Craftsmen Industries
Delta Zeta Sorority, Lindenwood University
Edward Jones
Faith in Action – Heritage Cluster UCC
Faith UMC, St. Charles
First Community State Bank, Warrenton
Friedens UCC, Troy
Friedens UCC, Warrenton
Girl Scouts of Eastern Missouri, Troop #435
Good Shepherd UCC, St. Charles
Graybar

Ivy Chapel, St. Louis
Kirkwood UCC Confirmands
Lindenwood University
Maryville University Reaches Out Day
MasterCard
Parkway UCC, St. Louis
Pi Theta Epsilon, Gamma Theta Ch., Maryville
Restore St. Charles
RGA Reinsurance Co.
Rubin Brown
St. Francis Borgia High School, Washington
St. Ignatius Loyola Grade School, Concord Hill
St. John UCC, Chesterfield
St. John UCC, St. Charles
St. John UCC, Weldon Spring
St. Johns UCC, Capeln

St. John's UCC, Manchester
St. Jordan's UCC, Beaufort
St. Lucas UCC Confirmands
St. Luke's UMC, St. Louis
St. Paul's UCC, Marthasville
St. Paul's UCC, Telegraph Rd.
The Fulton School of St. Albans
UMSL Golf Teams
UMSL Women's Basketball Team
UMSL Women's Soccer Team
Union Senior High School Students
United Healthcare
World Wide Technologies
Zion UCC, Union



Saturday Oct. 6th

370 Lakeside Park

Saint Peters, MO

**ALL PROCEEDS
BENEFIT:**



Emmaus

Presented By:



Warrenton Oil Co.

DUCKFESTMO.ORG FREE ENTRY CALLING CONTEST LIVE MUSIC RAFFLES

Save the Date!

125th Gala

1893-2018

Join Emmaus Homes as we
Celebrate 125 Years of History, Faith & Service.

FEBRUARY 23, 2019
Bogey Hills Country Club
Saint Charles, MO

More Information To Follow

3731 Mueller Rd.
St. Charles, MO 63301

NONPROFIT ORG
U.S. POSTAGE
PAID
ST. LOUIS, MO
PERMIT NO.783

STAY
CONNECTED



United Way
of Greater St. Louis

3731 Mueller Rd.
St. Charles, MO 63301

636-534-5200
www.emmaushomes.org

 **Emmaus**